

GENERAL NOTES:

1. Mobile Barriers MBT-1 is an integrated, rigid wall, trailer that must be used, in conjunction with a standard tandem drive axle tractor with 60 inches of swing clearance, to protect designated work zones. The intent is to utilize this safety device to provide enhanced safety to the onsite work force and the traveling public.
2. MBT-1 meets the following criteria:
 - National Co-operative Highway Research Program (NCHRP) Report #350 and MASH Test Level 3.
 - Accepted by FHWA letter of June 5, 2008 as a roadway safety device on the National Highway System and Federal aid eligible under #B-178.
 - Equipped with an energy attenuator that meets the requirements of NCHRP Report #350 or MASH Test Level 3, listed on the FDOT APL and width appropriate for a 8'-4" wide trailer.
 - Equipped with a high-intensity, rotating, flashing, oscillating or strobe lights.
 - Equipped with an Advance Warning Arrow Board listed on the FDOT APL and specified sign messages per FDOT Standard Index 600 series when used as a Shadow (S) or Advance Warning (AW) vehicle.
3. Manufacturer Contact Information:

Mobile Barriers LLC
 24918 Genesee Trail Road
 Golden, Colorado 80401
 Phone: (303) 526-5995
 Fax: (303) 526-9959
 Email: info@mobilebarriers.com
 Web: www.mobilebarriers.com
4. Assemble and install per the manufacture's recommendations.
5. MBT-1 applications are as:
 - A supplemental device to provide barrier protection for workers in work areas identified in FDOT index 600 series for TTC zones.
 - A barrier protection for motorist in hazardous work areas where short term work activities are occurring.
 - A rapid response barrier to provide barrier protection for motorists following an emergency roadway incident until other barrier protection can be provided.
 - A substitute for a specified vehicle in FDOT index 600 series for mobile operations that can not only provide advance warning, information to drivers and impact attenuation, but barrier protection for workers and a reduction of hazardous conditions for motorists.

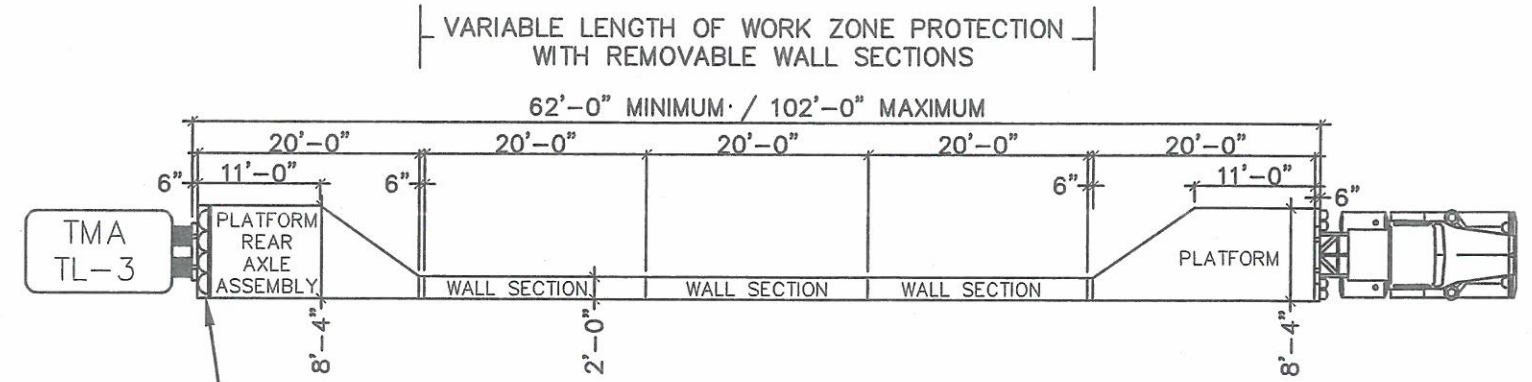

BASIC CONFIGURATION : PLAN VIEW

LOCATION OF ADVANCE WARNING ARROW BOARD AND SIGN MESSAGES PER FDOT STANDARD INDEX 600 SERIES.

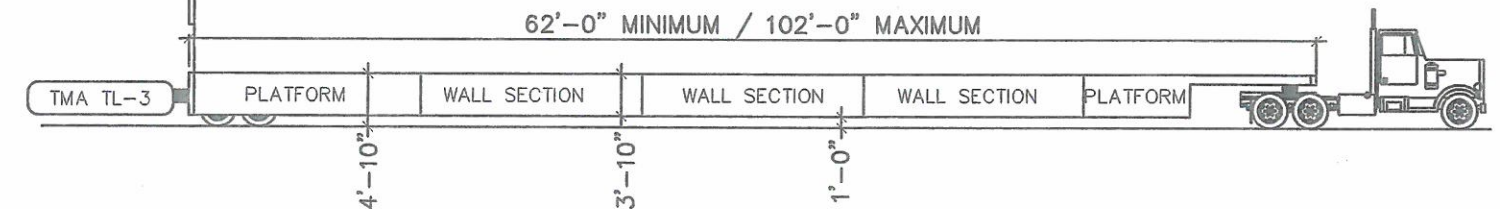

BASIC CONFIGURATION : ELEVATION VIEW

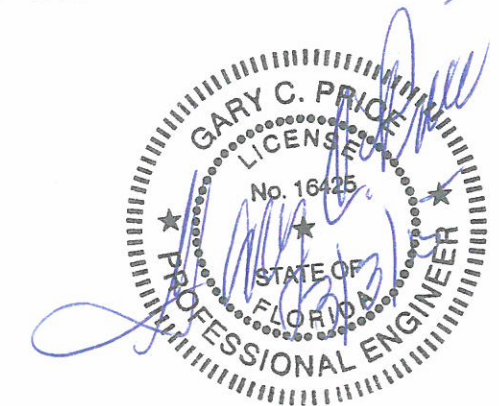

FHWA # B-178

MOBILE BARRIERS LLC

DRAWING DATE
03-03-15

MBT-1 Application
APL# 102-058-001

SHEET NO.
1 of 4

MBT-1 APPLICATION NOTES FOR FDOT 2015 DESIGN STANDARDS INDEXES 601 THROUGH 670:

The purpose of these Mobile Barriers MBT-1 drawings is to provide product information to FDOT, which will allow them to place this product on the Approved Products List (APL) and used by the them and others in work zones on roadways within Florida. These general MBT-1 application notes have been reviewed and are acceptable to FDOT as guidance in the application of this device within a traffic control plan (TCP) by the Engineer responsible for the TCP. These MBT-1 drawings can not be used as the TCP for any roadway project.

The following MBT-1 application notes are addressed in the matrix on this sheet for FDOT 2015 Design Standard Indexes 601 through 670. The note or notes that apply to a specific index is indicated by a "YES" beneath the number for the application note in the matrix. MBT-1 application notes are:

1. The MBT-1 is located at the beginning of and/or within the work area shown on the FDOT index.
2. Channelizing devices shown in the work area that would be adjacent to the MBT-1 are not required.
3. The traffic face of the MBT-1 may be flush with the edge of the adjacent travel lane.
4. As the MBT-1 proceeds or is relocated downstream within the designated work area, channelizing devices shall be placed at the required spacing from the end of the taper in advance of the designated work area along the appropriate longitudinal line to the MBT-1.
5. The MBT-1 may replace the Advance Warning (AW) vehicle when the work area is on the shoulder.
6. The MBT-1 may replace the Shadow (S) vehicle when the work is in the travel way.
7. The MBT-1 may replace the Shadow(S) vehicle located in the lane where the work is occurring.
8. The MBT-1 may not be placed in a closed lane between two open lanes. The non-barrier side shall be adjacent to a closed lane(s), shoulder or median.
9. A MBT-1 application is not recommended or not applicable.

FDOT INDEX NUMBER	APPLICABLE MBT-1 NOTE INDICATED BY "YES"								
	1	2	3	4	5	6	7	8	9
601	—	—	—	—	—	—	—	—	—
602	—	—	—	—	—	—	—	—	—
603	—	—	—	—	—	—	—	—	—
604	—	—	—	—	—	—	—	—	—
605	—	—	—	—	—	—	—	—	—
606	—	—	—	—	—	—	—	—	—
607	—	—	—	—	—	—	—	—	—
608	—	—	—	—	—	—	—	—	—
611	—	—	—	—	—	—	—	—	—
612	—	—	—	—	—	—	—	—	—
613 (Sheet 1)	—	—	—	—	—	—	—	—	—
613 (Sheet 2)	—	—	—	—	—	—	—	—	—
614	—	—	—	—	—	—	—	—	—
615	—	—	—	—	—	—	—	—	—
616	—	—	—	—	—	—	—	—	—
617	—	—	—	—	—	—	—	—	—
618	—	—	—	—	—	—	—	—	—
619	—	—	—	—	—	—	—	—	—
620	—	—	—	—	—	—	—	—	—
621	—	—	—	—	—	—	—	—	—
622	—	—	—	—	—	—	—	—	—
623	—	—	—	—	—	—	—	—	—
625	—	—	—	—	—	—	—	—	—
628	—	—	—	—	—	—	—	—	—
630	—	—	—	—	—	—	—	—	—
631	—	—	—	—	—	—	—	—	—
635	—	—	—	—	—	—	—	—	—
640	—	—	—	—	—	—	—	—	—
641	—	—	—	—	—	—	—	—	—
642	—	—	—	—	—	—	—	—	—
650	—	—	—	—	—	—	—	—	—
651	—	—	—	—	—	—	—	—	—
655	—	—	—	—	—	—	—	—	—
660	—	—	—	—	—	—	—	—	—
665	—	—	—	—	—	—	—	—	—
667	—	—	—	—	—	—	—	—	—
670	—	—	—	—	—	—	—	—	—

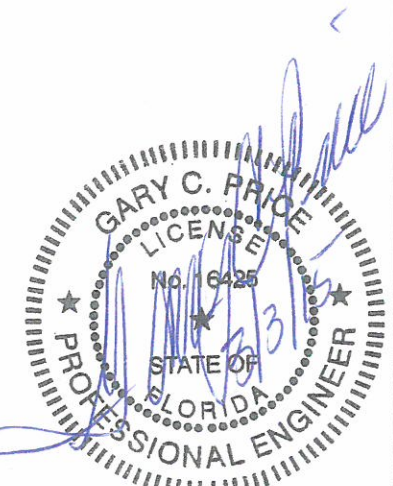

FHWA # B-178

MOBILE BARRIERS LLC	DRAWING DATE	MBT-1 Application APL# 102-058-001	SHEET NO.
	03-03-15		2 of 4

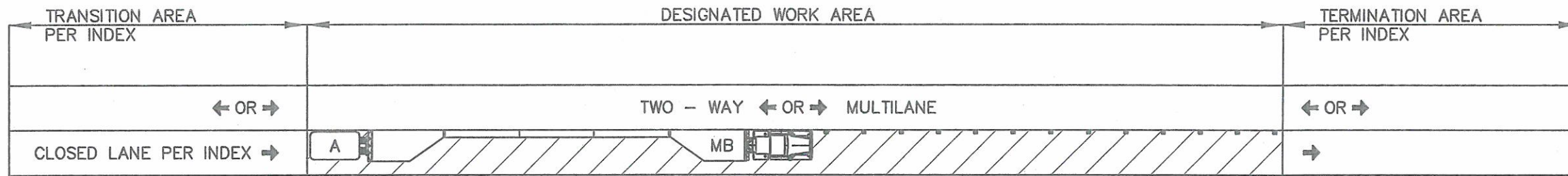

STEP 1 TO N

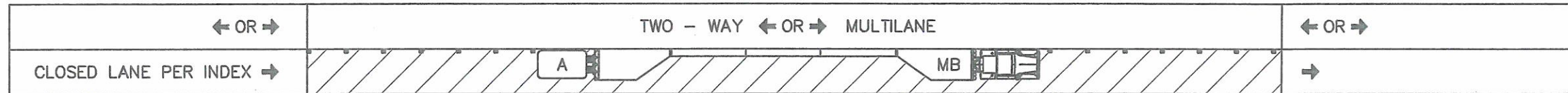

STEP 2 TO N

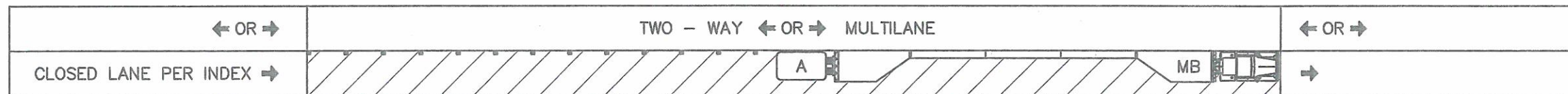

STEP N

This sequence of work progression applies to FDOT index designated work areas on a 2 lane, 2 way roadway with flagging or the outside (or median) lane of a 2 lane roadway in one direction. See MBT-1 application notes 1, 2, 3 and 4.

SYMBOLS

-  - Work Area
-  - Channelizing devices at spacing per index
-  - Lane identification and direction of traffic
-  - Mobile Barrier
-  - Arrow Board

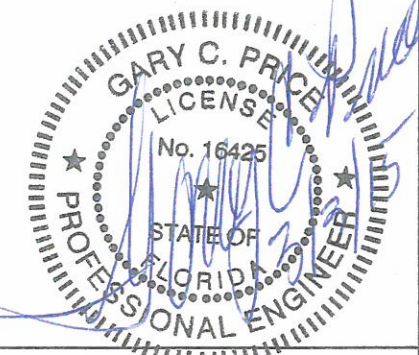

FHWA # B-178

MOBILE BARRIERS LLC

DRAWING DATE
03-03-15

MBT-1 Application
APL# 102-058-001

SHEET NO.
3 of 4

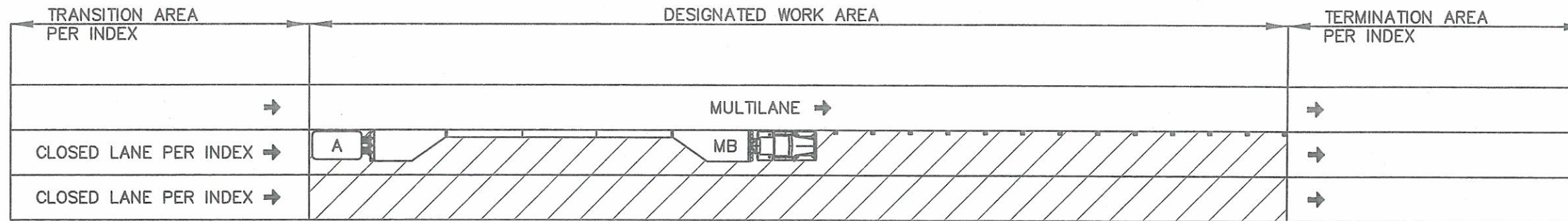

STEP 1 TO N

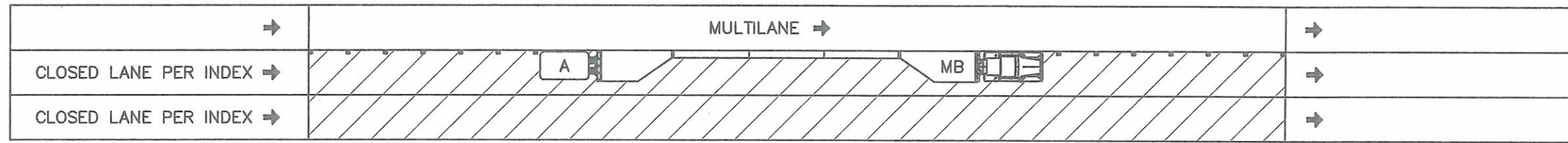

STEP 2 TO N

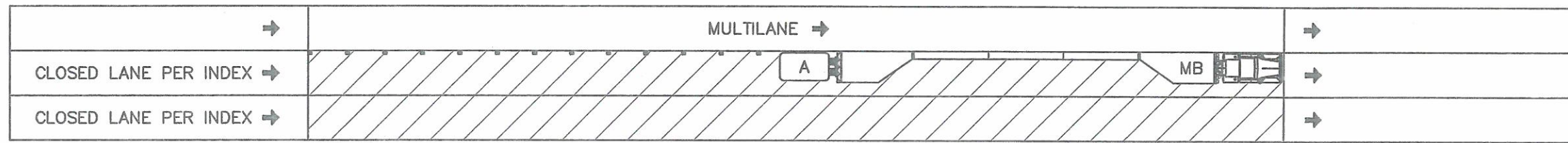

STEP N

This sequence of work progression applies to FDOT index designated work areas in the center or interior lane of a 3+ lane roadway in one direction. See MBT-1 application notes 1, 2, 3, 4, 6, 7 and 8.

SYMBOLS

- Work Area
- Channelizing devices at spacing per index
- Lane identification and direction of traffic
- Mobile Barrier
- Arrow Board

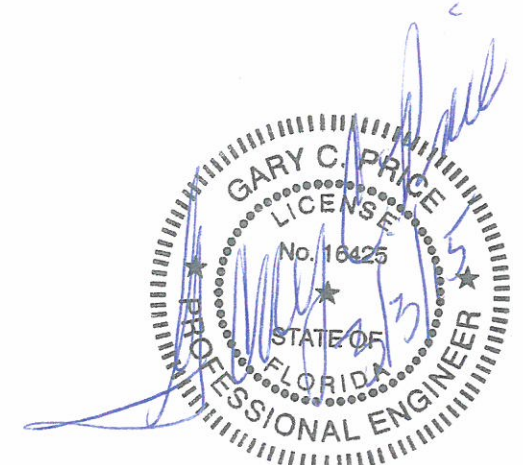
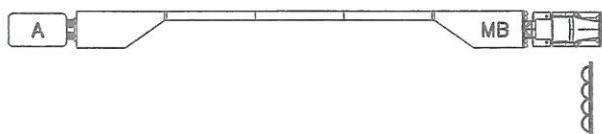

FHWA # B-178

MOBILE BARRIERS LLC

DRAWING DATE
03-03-15

MBT-1 Application
APL# 102-058-001

SHEET NO.
4 of 4